

Notes:

- CONTROL PANEL, (BATTERY CHARGER INSIDE).
- 120V, 20A GFCI & 250V, 15A OUTLET (OPTIONAL).
- CONNECTION POINTS FOR CONTROL WIRES PROVIDED IN THE LOW VOLTAGE CONNECTION BOX (USE LOW VOLTAGE STUB-UP AREA).
- BATTERY (12 VOLT NEGATIVE GROUND SYSTEM).
- MAIN LINE CIRCUIT BREAKER (MLCB), AC LOAD LEADS. (DIMENSIONS MAY VARY DUE TO UNIT CONFIGURATION)
- CENTER OF GRAVITY AND WEIGHT MAY CHANGE DUE TO UNIT OPTIONS. FOR WEIGHT AND CENTER OF GRAVITY DATA SEE SHEET 3
- ENGINE SERVICE CONNECTIONS:  
 INLET NATURAL GAS = 1-1/4" NPT FEMALE COUPLING  
 INLET DIESEL = N/A  
 RETURN DIESEL = N/A  
 OIL DRAIN = 1/2" NPT COUPLING  
 RADIATOR DRAIN = 1/2 NPT COUPLING,  
 FLEX PIPE OUTLET = 2.5" ID - WELD ON FLANGE PROVIDED  
 EXHAUST OUTLET = N/A  
 \*\*\*\*\* SEE GENERATOR SIZING GUIDE FOR FUEL PIPE SIZING TO SUIT APPLICATION \*\*\*\*\*
- AUXILIARY AC CONNECTION FOR UNIT OPTIONS ARE LOCATED IN HIGH VOLTAGE CONNECTION BOX, UNLESS AN OPTIONAL LOAD CENTER IS INSTALLED.
- EXHAUST PIPES MAY BE ROTATED TO ALLOW MUFFLER TO POINT OUT TO THE RIGHT OR LEFT SIDE OF GENERATOR. (MAY NOT APPLY TO ALL UNITS)
- GENERATOR SET MUST BE INSTALLED SUCH THAT FRESH COOLING AIR IS AVAILABLE AND DISCHARGE AIR FROM THE RADIATOR IS NOT RECIRCULATED.
- BOTTOM OF GENERATOR SET MUST BE ENCLOSED TO PREVENT PEST INTRUSION AND RECIRCULATION OF DISCHARGE AIR AND/OR IMPROPER COOLING AIR FLOW.
- EXHAUST SYSTEM MAXIMUM BACK PRESSURE = 10" H2O (ADDITIONAL).
- INSTALL EXHAUST BLANKETS ALONG THIS LINE.
- CONNECT THE OPEN SET EXHAUST PER NFPA 37
- BLANKETS SHOULD NOT COVER OXYGEN SENSOR.
- OXYGEN SENSOR (IF EQUIPPED) MUST BE MOUNTED BETWEEN ENGINE OUTLET AND CATALYST INLET IN PORT PROVIDED.
- CATALYST MUST BE MOUNTED IN DESCRIBED POSITION. FAILING TO FOLLOW THESE INSTRUCTIONS WHEN INSTALLING A CERTIFIED ENGINE IN A PIECE OF STATIONARY EQUIPMENT VIOLATES FEDERAL LAW 40CFR 1068.105(b), SUBJECT TO FINES OR PENALTIES AS DESCRIBED IN THE CLEAN AIR ACT.
- BOLTS OR STUDS USED TO MOUNT UNIT TO PAD SHALL BE 5/8 - 11 GRADE 5.

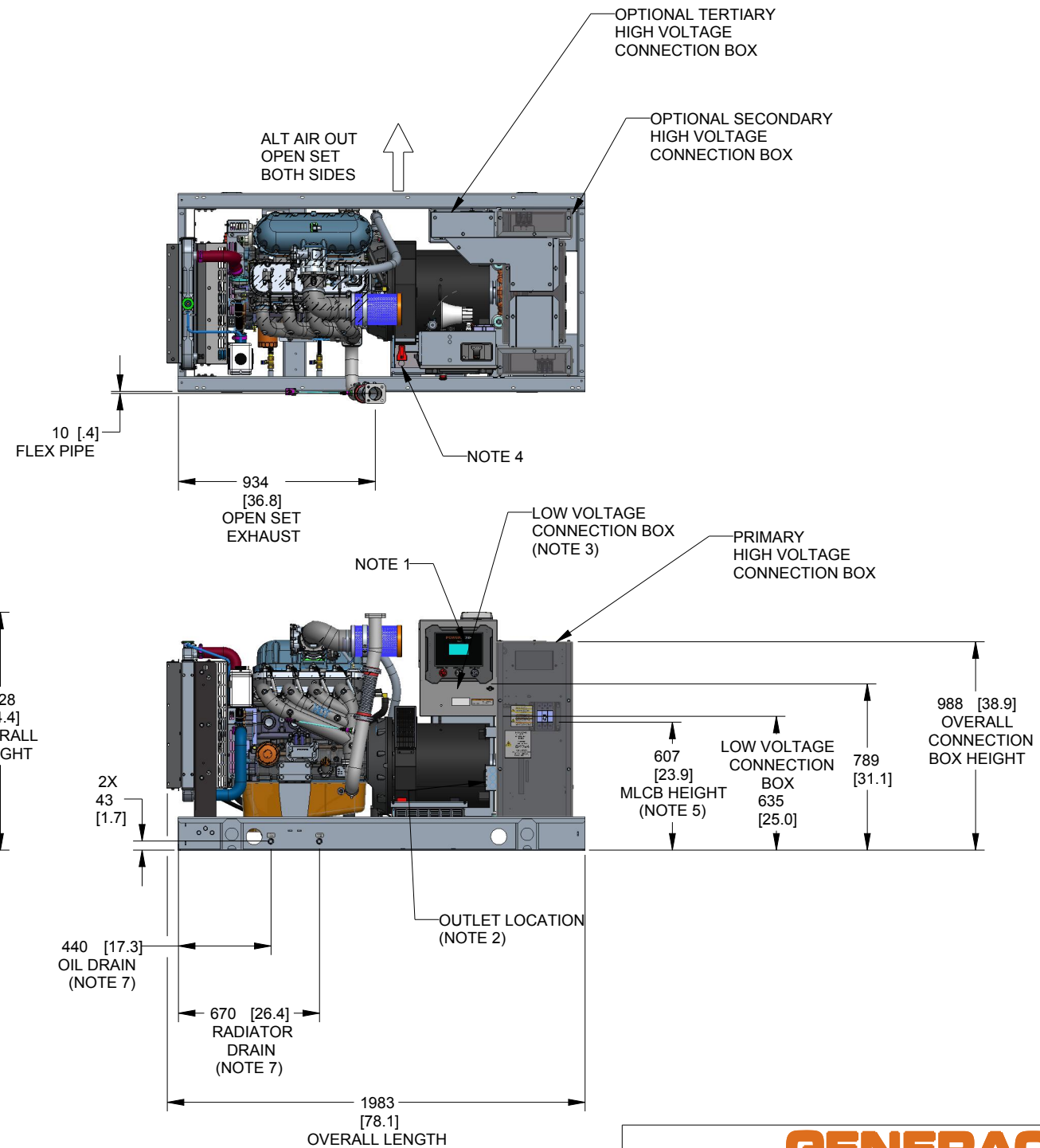

DRAWING CREATED FROM PRO/ENGINEER 3D FILE. ECO MODIFICATION TO BE APPLIED TO SOLID MODEL ONLY.

DIMENSIONS ARE IN MILLIMETERS [INCHES]



TITLE				
OPEN SET G4.5L 60Hz SG35, SG40, SG45, SG50				
ISSUE DATE:				
SIZE	CAGE NO	DWG NO	REV	
B	N/A	A0000292914	C	
SCALE	0.035	WT-KG	SHEET	1 of 3

# INSTALLATION DRAWING

GENERAC POWER SYSTEMS OWNS THE COPYRIGHT OF THIS DRAWING WHICH IS SUPPLIED IN CONFIDENCE AND MUST NOT BE USED FOR ANY PURPOSE OTHER THAN FOR WHICH IT IS SUPPLIED WITHOUT THE EXPRESS WRITTEN CONSENT OF GENERAC POWER SYSTEMS. ©GENERAC POWER SYSTEMS 2013

ELECTRONICALLY APPROVED  
INSIDE WINDCHILL

4

3

SH

2/3

REV

C

WINDCHILL VERSION

C.5

1

RECOMENDED ELECTRICAL STUB-UP  
 (HIGH VOLTAGE STUB-UP)  
 AC LOAD LEAD CONDUIT FOR  
 PERMANENT MAGNET EXCITATION  
 CONNECTION BOX  
 LOW VOLTAGE STUB-UP

B

B

A

A

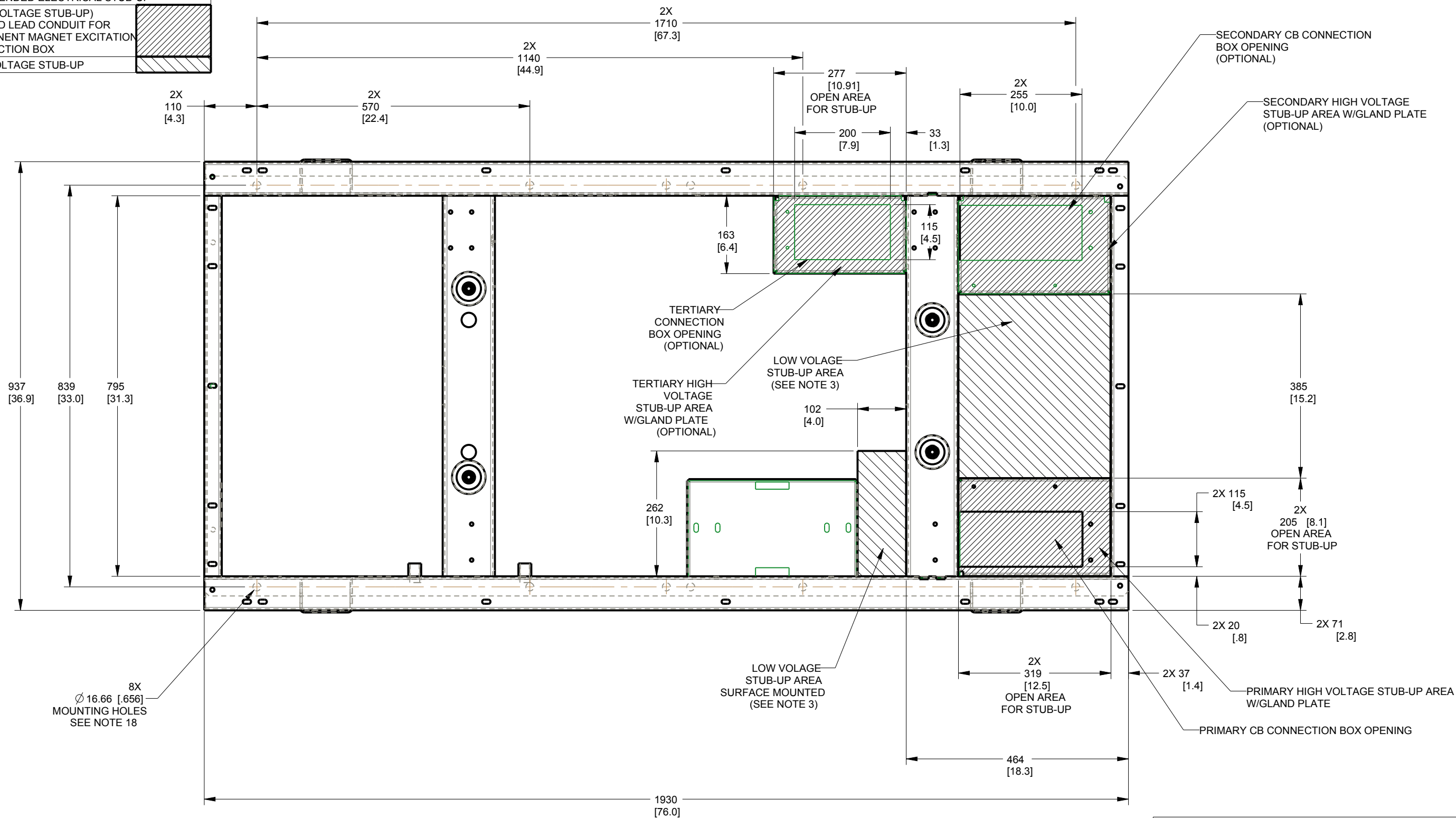

DRAWING CREATED FROM PRO/ENGINEER 3D FILE. ECO MODIFICATION TO BE APPLIED TO SOLID MODEL ONLY.

DIMENSIONS ARE IN MILLIMETERS [INCHES]



TITLE				
STUB-UP G4.5L 60Hz SG35, SG40, SG45, SG50				
ISSUE DATE:				
SIZE	CAGE NO	DWG NO	REV	
B	N/A	A0000292914	C	
SCALE	WT-KG	SHEET		2 of 3
0.120				

GENERAC POWER SYSTEMS OWNS THE COPYRIGHT OF THIS DRAWING WHICH IS SUPPLIED IN CONFIDENCE AND MUST NOT BE USED FOR ANY PURPOSE OTHER THAN FOR WHICH IT IS SUPPLIED WITHOUT THE EXPRESS WRITTEN CONSENT OF GENERAC POWER SYSTEMS. ©GENERAC POWER SYSTEMS 2013

ELECTRONICALLY APPROVED  
INSIDE WINDCHILL

# INSTALLATION DRAWING

4

3

2

1

OPEN SET

MODEL	VOLTAGE	WEIGHT	CENTER OF GRAVITY DIM X	CENTER OF GRAVITY DIM Y	CENTER OF GRAVITY DIM Z
SG35, SG40, SG45, SG50	220V, 240V, Ø	759.8 kg [1675 lbs.]	1038 [40.9]	551 [21.7]	444 [17.5]
SG35, SG40, SG45, SG50	600V	763.4 kg [1683 lbs.]	1038 [40.9]	551 [21.7]	
SG35, SG40, SG45, SG50	208V, 240V, 400V, 480V	765.2 kg [1687 lbs.]	1038 [40.9]	551 [21.7]	
SG35, SG40, SG45, SG50	220V, 240V, Ø UPSIZE	787.4 kg [1736 lbs.]	1014 [40]	546 [21.5]	
SG35, SG40, SG45, SG50	600V UPSIZE	791.1 kg [1744 lbs.]	1012 [39.8]	545 [21.5]	
SG35, SG40, SG45, SG50	208V, 240V, 400V, 480V UPSIZE	792.9 kg [1748 lbs.]	1011 [39.8]	545 [21.5]	

STD ENCLOSURE, STEEL

MODEL	VOLTAGE	WEIGHT	CENTER OF GRAVITY DIM X	CENTER OF GRAVITY DIM Y	CENTER OF GRAVITY DIM Z
SG35, SG40, SG45, SG50	220V, 240V, Ø	979.8 kg [2160 lbs.]	1069 [42.1]	614 [24.2]	448 [17.6]
SG35, SG40, SG45, SG50	600V	983.4 kg [2168 lbs.]	1069 [42.1]	614 [24.2]	
SG35, SG40, SG45, SG50	208V, 240V, 400V, 480V	985.2 kg [2172 lbs.]	1068 [42]	614 [24.2]	
SG35, SG40, SG45, SG50	220V, 240V, Ø UPSIZE	1007.4 kg [2221 lbs.]	1054 [41.5]	608 [23.9]	
SG35, SG40, SG45, SG50	600V UPSIZE	1011.1 kg [2229 lbs.]	1053 [41.5]	607 [23.9]	
SG35, SG40, SG45, SG50	208V, 240V, 400V, 480V UPSIZE	1012.9 kg [2233 lbs.]	1052 [41.4]	607 [23.9]	

STD ENCLOSURE, ALUMINUM

WEIGHT	CENTER OF GRAVITY DIM X	CENTER OF GRAVITY DIM Y	CENTER OF GRAVITY DIM Z
859.1 kg [1894 lbs.]	1051 [41.4]	601 [23.7]	447 [17.6]
861.8 kg [1900 lbs.]	1051 [41.4]	601 [23.7]	
863.6 kg [1904 lbs.]	1051 [41.4]	600 [23.6]	
886.8 kg [1955 lbs.]	1035 [40.7]	595 [23.4]	
889.5 kg [1961 lbs.]	1034 [40.7]	595 [23.4]	
891.3 kg [1965 lbs.]	1034 [40.7]	594 [23.4]	

L1A ENCLOSURE, STEEL

MODEL	VOLTAGE	WEIGHT	CENTER OF GRAVITY DIM X	CENTER OF GRAVITY DIM Y	CENTER OF GRAVITY DIM Z
SG35, SG40, SG45, SG50	220V, 240V, Ø	1024.2 kg [2258 lbs.]	1071 [42.2]	616 [24.3]	449 [17.7]
SG35, SG40, SG45, SG50	600V	1026.9 kg [2264 lbs.]	1070 [42.1]	616 [24.3]	
SG35, SG40, SG45, SG50	208V, 240V, 400V, 480V	1028.7 kg [2268 lbs.]	1070 [42.1]	616 [24.3]	
SG35, SG40, SG45, SG50	220V, 240V, Ø UPSIZE	1051.9 kg [2319 lbs.]	1058 [41.7]	611 [24.1]	
SG35, SG40, SG45, SG50	600V UPSIZE	1054.6 kg [2325 lbs.]	1057 [41.6]	611 [24.1]	
SG35, SG40, SG45, SG50	208V, 240V, 400V, 480V UPSIZE	1056.4 kg [2329 lbs.]	1057 [41.6]	610 [24]	

L1A ENCLOSURE, ALUMINUM

WEIGHT	CENTER OF GRAVITY DIM X	CENTER OF GRAVITY DIM Y	CENTER OF GRAVITY DIM Z
901.3 kg [1987 lbs.]	1056 [41.6]	604 [23.8]	447 [17.6]
904.1 kg [1995 lbs.]	1056 [41.6]	604 [23.8]	
906.7 kg [1999 lbs.]	1056 [41.6]	604 [23.8]	
929 kg [2048 lbs.]	1042 [41]	599 [23.6]	
932.6 kg [2056 lbs.]	1041 [41]	599 [23.6]	
934.9 kg [2061 lbs.]	1041 [41]	598 [23.5]	

L2A ENCLOSURE, STEEL

MODEL	VOLTAGE	WEIGHT	CENTER OF GRAVITY DIM X	CENTER OF GRAVITY DIM Y	CENTER OF GRAVITY DIM Z
SG35, SG40, SG45, SG50	220V, 240V, Ø	1061.9 kg [2341 lbs.]	1076 [42.4]	626 [24.6]	452 [17.8]
SG35, SG40, SG45, SG50	600V	1065.5 kg [2349 lbs.]	1076 [42.4]	626 [24.6]	
SG35, SG40, SG45, SG50	208V, 240V, 400V, 480V	1067.3 kg [2353 lbs.]	1076 [42.4]	626 [24.6]	
SG35, SG40, SG45, SG50	220V, 240V, Ø UPSIZE	1089.5 kg [2402 lbs.]	1064 [41.9]	621 [24.4]	
SG35, SG40, SG45, SG50	600V UPSIZE	1093.2 kg [2410 lbs.]	1063 [41.9]	620 [24.4]	
SG35, SG40, SG45, SG50	208V, 240V, 400V, 480V UPSIZE	1095.4 kg [2415 lbs.]	1063 [41.9]	620 [24.4]	

L2A ENCLOSURE, ALUMINUM

WEIGHT	CENTER OF GRAVITY DIM X	CENTER OF GRAVITY DIM Y	CENTER OF GRAVITY DIM Z
939.4 kg [2071 lbs.]	1063 [41.9]	612 [24.1]	450 [17.7]
943 kg [2079 lbs.]	1063 [41.9]	612 [24.1]	
944.8 kg [2083 lbs.]	1063 [41.9]	612 [24.1]	
966.6 kg [2131 lbs.]	1049 [41.3]	607 [23.9]	
970.7 kg [2140 lbs.]	1049 [41.3]	606 [23.9]	
972.5 kg [2144 lbs.]	1048 [41.3]	606 [23.9]	

DRAWING CREATED FROM PRO/ENGINEER 3D FILE. ECO MODIFICATION TO BE APPLIED TO SOLID MODEL ONLY.

DIMENSIONS ARE IN MILLIMETERS [INCHES]



TITLE

OPEN SET  
G4.5L 60Hz  
SG35, SG40, SG45, SG50

ISSUE DATE:

SIZE B	CAGE NO N/A	DWG NO A0000292914	REV C
SCALE 0.035	WT-KG	SHEET 3 of 3	

GENERAC POWER SYSTEMS OWNS THE COPYRIGHT OF THIS DRAWING WHICH IS SUPPLIED IN CONFIDENCE AND MUST NOT BE USED FOR ANY PURPOSE OTHER THAN FOR WHICH IT IS SUPPLIED WITHOUT THE EXPRESS WRITTEN CONSENT OF GENERAC POWER SYSTEMS. ©GENERAC POWER SYSTEMS 2013

ELECTRONICALLY APPROVED  
INSIDE WINDCHILL

# INSTALLATION DRAWING